

Ego Flat 150-220 Down Light / Ego Flat Vetro 150-220 Down Light

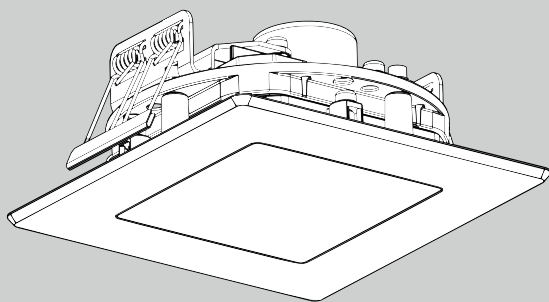

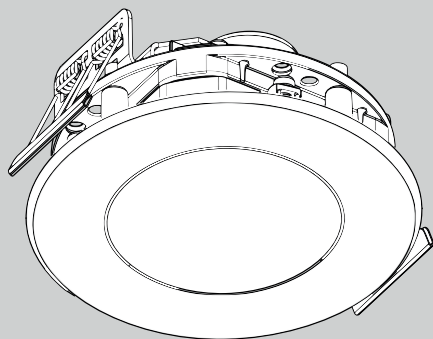

i

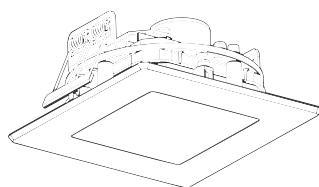
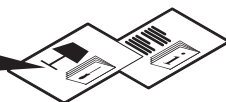
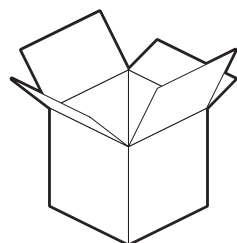
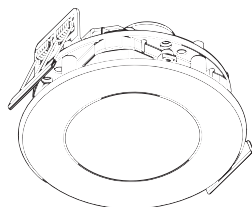
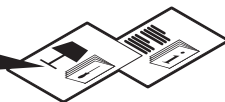
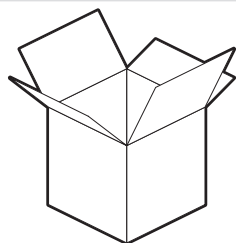
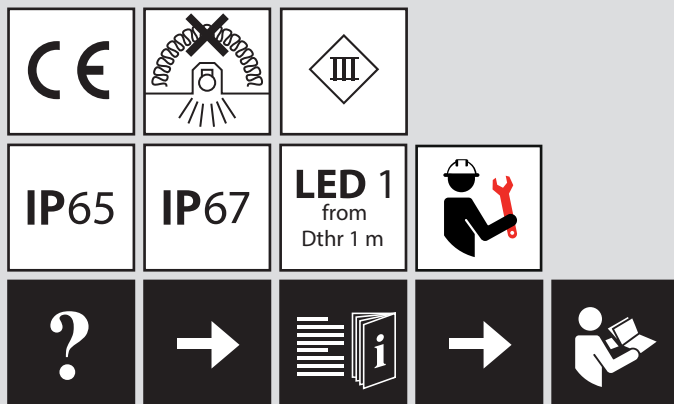

Ego Flat 150-220 Down Light

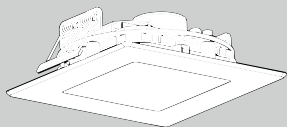

150 x 150 mm
220 x 220 mm

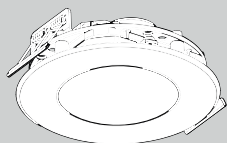

Ø 150 mm
Ø 220 mm

Ego Flat vetro 150-220 Down Light

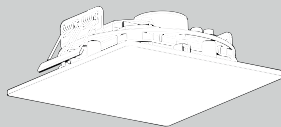

150 x 150 mm
220 x 220 mm

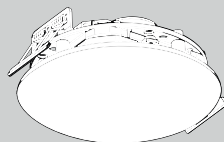

Ø 150 mm
Ø 220 mm

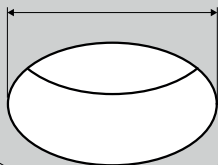

Ego Flat 150 Ø : 135 mm +/- 2mm
Ego Flat 220 Ø : 203 mm +/- 2mm
Ego Flat 150 □ : 135 mm x 135 mm +/- 2mm
Ego Flat220 □ : 203 mm x 203 mm +/- 2mm

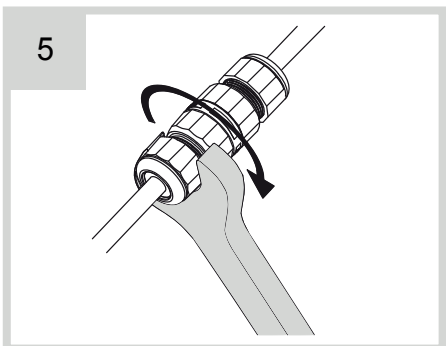
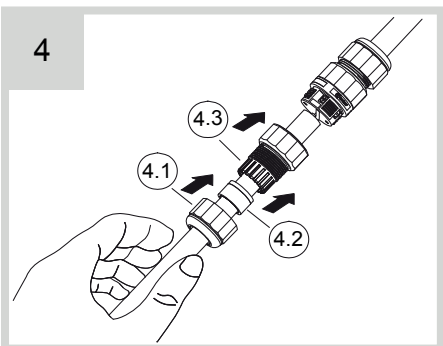
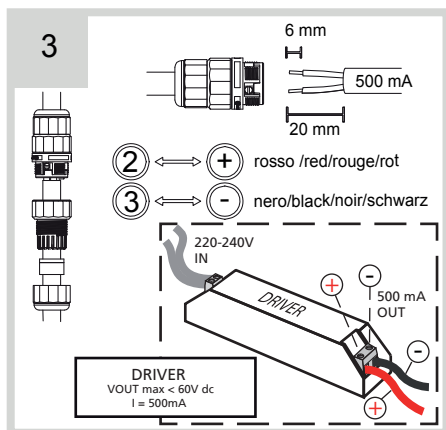
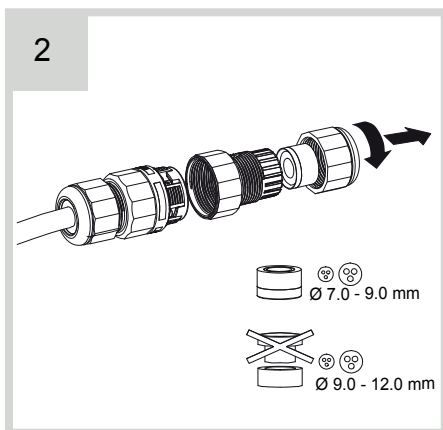
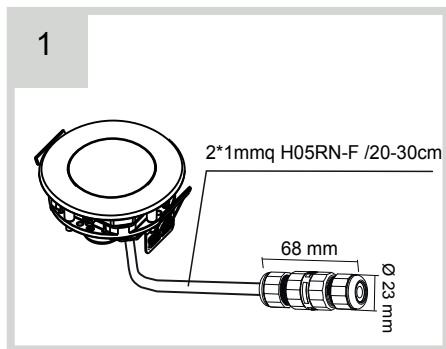
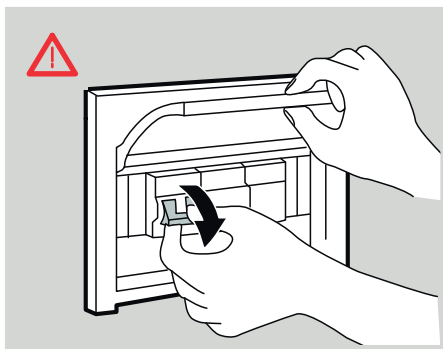

Collegamento in serie - Series connection - Connection en série
Hintereinander schaltung - Conexion en serie

Per evitare di danneggiare il LED effettuare tutti i collegamenti prima di dare tensione.

To avoid damages to LED unit all connection shall be made before to switch power on.

6

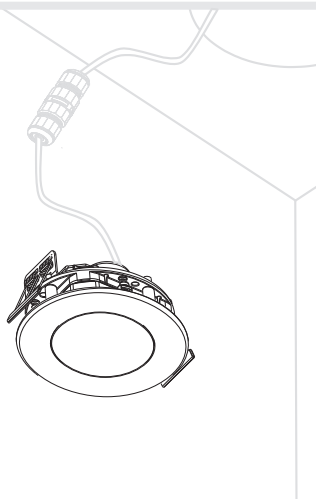

7

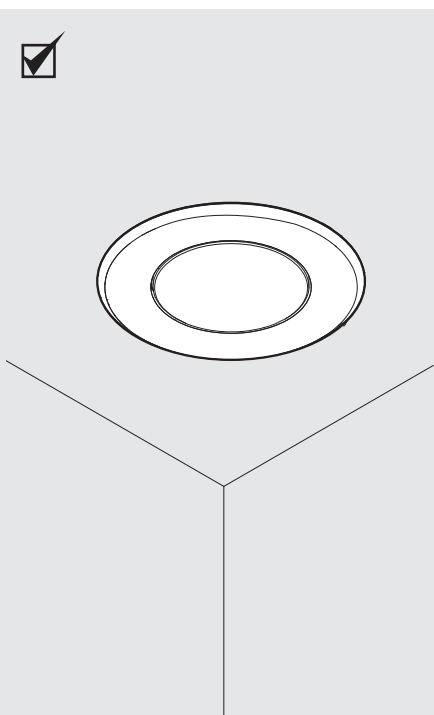
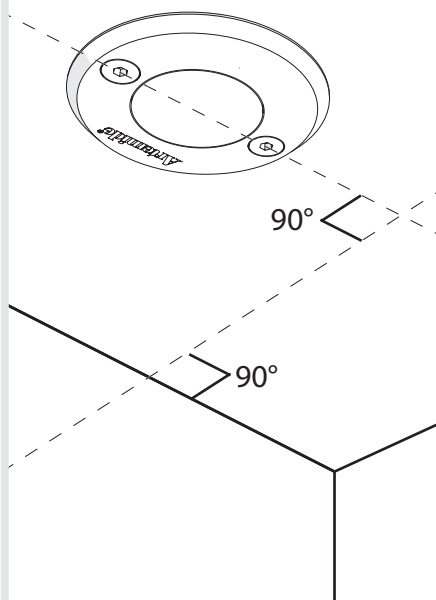
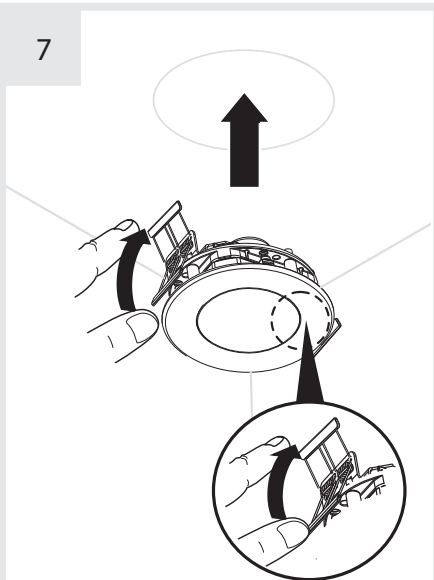

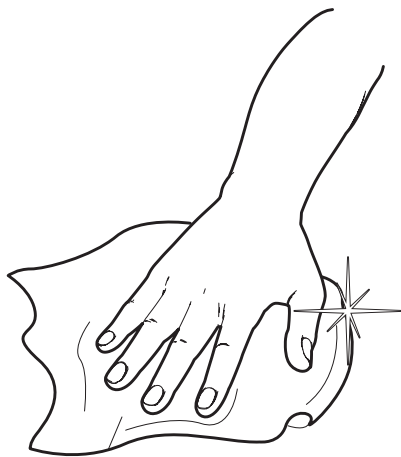
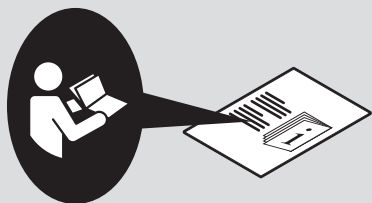

Artemide®



Artemide Spa

via Bergamo, 18
20010 Pregnana M.se (MI)
ITALIA

Tel. +39 02 935 181
Fax +39 02 935 90 254
Fax +39 02 935 90 496

www.artemide.com

VAT IT00846890150

cod. Y513000348D